

FreeStyle
Libre 2

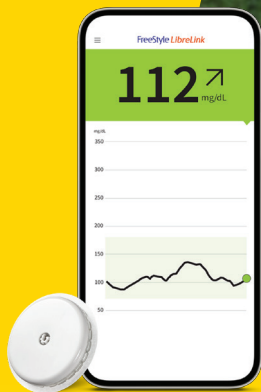

Get started with the FreeStyle Libre 2 Plus Sensor

FreeStyle Libre 2 Plus Sensor tracks your glucose in real time, all day long. You'll know the moment when your glucose is too low, too high with optional alarms¹ so you can make more confident choices.

Let's get started.

Now track your glucose levels every minute, without finger pricks² or the need to scan³.

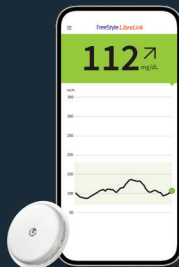

Freestyle Libre Vs Finger Prick	01
BGM vs CGM	02
How CGM works	03
Benefits	04
How to Use	06
Connected Care	07
Getting Started	08
Application	09
Start Your Sensor	11
Glucose Readings	15
Optional Alarms	18
Reports	20
Sharing Data	22
Live Your Life	25
Travel	26
Removing Sensor	27
Checklist	28
Frequently Asked Questions	29

FreeStyle Libre 2 Plus Sensor shows your full glucose picture with real-time readings every minute³.



Finger Prick Tests

BLOOD GLUCOSE MONITORING (BGM)

Only gives a snapshot of your blood sugar levels at one moment. It can miss the important changes that happen throughout the day.

FreeStyle Libre 2 System

CONTINUOUS GLUCOSE MONITORING (CGM)

Uncover glucose highs and lows with automatic, real-time readings every minute³ and make more informed decisions.

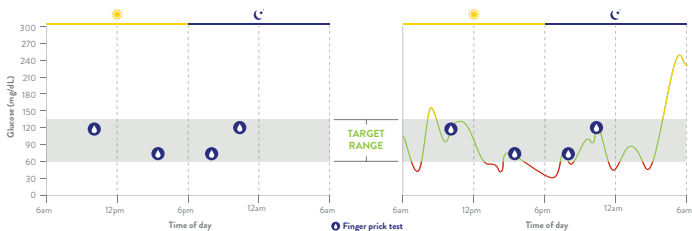

FreeStyle Libre 2: A better, easier way to monitor glucose.

A continuous glucose monitoring system (CGM) that measures glucose levels from the interstitial fluid beneath the skin instead of blood, so there are no finger pricks² required.

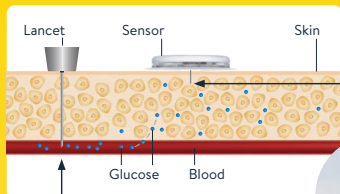

BGM



With blood glucose monitoring (BGM) every reading is taken from the blood with a finger prick².

FreeStyle Libre 2 Plus Sensor

Readings are continuously measured from beneath the skin by a tiny filament attached to the sensor.



The tiny filament under the sensor is as thin as a strand of thread, making the sensor painless⁴ to apply and wear.

	BGM 	FreeStyle Libre 2 Plus Sensor (CGM) 
Current reading	✓	✓
Continuous tracking	✗	✓
Trend arrow ⁹	✗	✓
Glucose alarms	✗	✓
Highs/low detection	– Per prick	✓ 24/7, day and night ⁵
Ease	✗ Daily life disruptions	✓ Painless ⁴ and discreet ⁶
Frequency	✗ Per prick, often skipped	✓ Automatic, every minute ³
Real-time connectivity	– Variable	✓ With your doctor ✓ With loved ones
Accuracy	– Variable	✓ Factory-calibrated

CGM readings can be about 5 to 10 minutes behind BGM

Glucose enters the bloodstream first, so blood glucose readings change before sensor glucose readings do. Sensor and finger prick results may be different at times when glucose is changing rapidly, like after eating, exercising, or taking medication. That means your CGM readings will either be above or below your BGM readings at first. This is known as “the lag.”

Let’s use a train to demonstrate the difference between CGM and BGM readings.

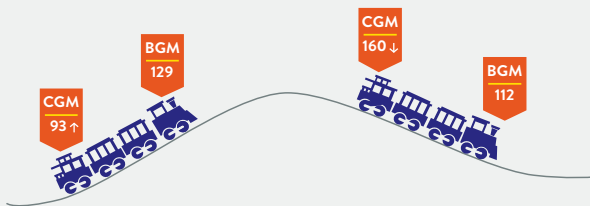

CGM=Continuous Glucose Monitoring | **BGM**=Blood Glucose Monitoring

Factors that can affect sensor glucose readings:

- You are in the first day of wearing a new sensor.
- Your sensor is not securely applied.
- Your sensor kit was stored somewhere outside of the recommended temperature range (10°C to 45°C).

Glucose management redefined



Zero finger pricks²

Glucose readings are automatically sent to your phone every minute³.

15

Small and discreet⁴ sensor

15 days of comfortable wear⁴; most accurate⁷ & consistent readings



Real-time readings every minute³

Real-time glucose insights so you can take timely action without the need to scan³



Enjoy peace of mind⁸

Optional alarms¹ for timely action when glucose goes too high or too low.



Turn small steps into big wins

Know how food, lifestyle & medication impact your glucose levels.



A complete picture of glucose

Fill in up to 8 hours of missing data.

Benefits

Meet the FreeStyle Libre 2 system



The **FreeStyle Libre 2 Plus** sensor is contained within the sensor pack. After applying your **sensor** using the **applicator**, use the **FreeStyle LibreLink App*** to start your sensor. Then you'll use the App* to start receiving glucose readings, get optional glucose alarms¹, and see your glucose history and any notes you have added.

Multiple studies showed the benefits of using the FreeStyle Libre 2 system



Lower HbA1c^{9,10}

Significantly lower your HbA1c^{9,10} without finger pricks²



Less time in low glucose^{4,11}

Spend less time in low glucose (<70 mg/dL), both during the day and at night^{4,11}



More time in range⁹

Increase time spent in your target glucose range (70–180 mg/dL)⁹

Easily see where your sugar levels are, have been, and are going.

Your current glucose reading

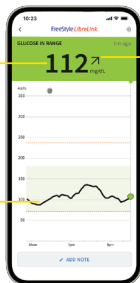

Trend arrow shows where your glucose is heading and how fast it's changing

Glucose trend line shows response to food, activity and medication - day and night

Optional glucose alarms¹ give you more peace of mind⁸



Low glucose alarm
can be set between
60-100 mg/dL



High glucose alarm
can be set between
120-400 mg/dL

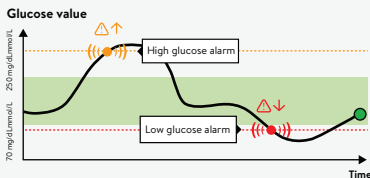

Easy to
turn on/off⁶



Easy-to-adjust
sound and vibration⁶



Easily monitor your glucose on your smartphone anytime,¹² anywhere,¹³ and share results.*



Easy monitoring⁴

One app allows you to monitor and share your glucose readings⁴

LibreView[^]

Easy insights⁵

Share glucose readings with your healthcare team for more effective consultations⁵



LibreLinkUp[#] Easy connection

Share glucose levels with your loved ones⁸

Setting up the FreeStyle LibreLink App*



Download the FreeStyle LibreLink App* on your phone from Apple App Store / Google Play Store



A. Create new account

1. Click 'Get started now' to create account
2. Select the country of residence (i.e. India)
3. Accept Terms of Use and Privacy Notice
4. Enter personal information and set up password

B. Set range and units

1. Select the target glucose range as recommended by your doctor
2. Click 'Done' to go to next step



Review and accept the requested permissions

Scan the QR code to view compatibility guide or visit website www.FreeStyleLibre.co.in



You are now ready start your sensor!

Applying the FreeStyle Libre 2 Plus Sensor



Back of the upper arm is recommended for applying the sensor



- 1 Wash**
Only use non-moisturising soaps to wash the area where you will apply the sensor.



- 2 Clean**
Use a wipe to clean the site and ensure the area is free of hair (consider shaving the area).



- 3 Dry**
Allow your skin to fully dry before applying the sensor. This is especially important if you plan to apply the sensor after shower or swim.

Prepare the Sensor

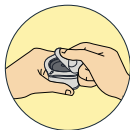

- 1 Peel back and remove the lid from the sensor pack.

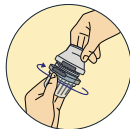

- 2 Unscrew the cap of the sensor applicator. You will hear a click.

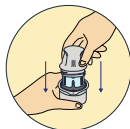

- 3 Align the line on the sensor applicator with the line on the pack.

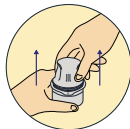

- 4 Firmly push the applicator onto the pack.



- 5 Finally, remove the applicator. The sensor is now attached and ready for application.



IMPORTANT

This must be performed on a flat surface for proper sensor connection

Start your Sensor

Getting started with the FreeStyle LibreLink App*



Open the FreeStyle LibreLink App*



Scan the sensor. You'll receive a tone & vibration when it's activated



Wait for 60 minutes post application.



You will receive notification that the sensor is ready to go



For iOS

- **Scan readiness** : Unlock iPhone, open the App, and tap scan button in the App to put the phone in a 'scan ready' state
- **Scan technique** : Scan the sensor with the top of the iPhone
- **Report navigation** : When viewing a report, select from a drop-down menu



For Android

- **Scan readiness** : No action is required to put the phone in a 'scan ready' state when NFC is enabled
- **Scan technique** : Scan the sensor with the back of the Android phone
- **Report navigation** : When viewing a report, swipe through a 'carousel' to view other reports



IMPORTANT

Make sure your Bluetooth is on, to receive data automatically every minute³

User starts FreeStyle Libre 2 Plus sensor with the FreeStyle LibreLink* App



Provides alarms and glucose readings **automatically**³ on the app or with a scan on the app



LibreView[^]

Shares reports **automatically**³ in LibreView[^]

LibreLinkUp[#]

Shares glucose readings and alarms **automatically**³ on the LibreLinkUp App[#]

User starts FreeStyle Libre 2 Plus sensor with the reader

Provides alarms and glucose readings with a scan on the FreeStyle Libre² reader



FreeStyle
LibreLink

Provides only glucose readings (with a scan) on the app



Scanning experience offers the flexibility to use both the reader and app



LibreView[^]

Shares reports in LibreView[^] (based on scanned readings)⁵



LibreLinkUp[#]

Shares glucose readings to LibreLinkUp[#] App (after a scan on the FreeStyle LibreLink App*)

Glucose Readings

See your glucose at a glance.

Glucose message

Current glucose reading is updated every minute³.

Optional high and low glucose alarm¹ levels.

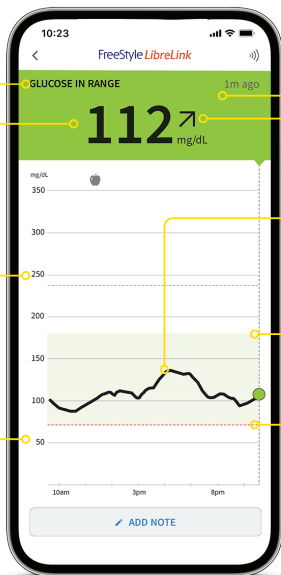

Glucose graph shows your 12-hour history.

Target glucose range is set at 70-180 mg/dL and can be customized.

FreeStyle LibreLink App*

Glucose readings determine background color at top of phone screen.

ORANGE

High glucose
(above 250
mg/dL)

YELLOW

Between the
target glucose
range and high or
low glucose level

GREEN

Within the target
glucose range
(70-180 mg/dL
is standard, but
target range can
be customized)

RED

Low glucose
(below 70
mg/dL)

Trend arrows show where your glucose levels are headed.

Arrow direction	What trend arrow means
↑	Glucose is rising quickly more than 2 mg/dL per minute
↗	Glucose is rising between 1 and 2 mg/dL per minute
→	Glucose is changing slowly less than 1 mg/dL per minute
↘	Glucose is falling between 1 and 2 mg/dL per minute
↓	Glucose is falling quickly more than 2 mg/dL per minute

Glucose Readings

Review your time-in-range report

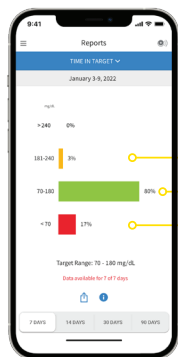

On the App*:

Tap the Insights tab to view reports.

Above target glucose range
>180 mg/dL

Target glucose range
70-180 mg/dL

Below target glucose range
<70 mg/dL

Glucose History

The graph shows glucose data from the past 8 hours and the shaded green ribbon shows the target range set by you.

Add Note

Track food, insulin use, exercise, and other events. An icon is then added to the top of the graph to represent the type and time of noted event.



Food



Long-Acting Insulin



Exercise



Rapid-Acting Insulin

Optional alarms¹ help you know when to take action.



High glucose alarm

can be set between 120 and 400 mg/dL.



Low glucose alarm

can be set between 60 and 100 mg/dL.



Sensor signal loss

alerts if your phone has not communicated with your sensor in over 20 minutes.



Glucose alarm levels and target glucose range levels are different and can be customized independently. Talk to your doctor about both.

Optional Alarms

On the App*:

- 1 On your **Navigation Bar**, tap **Alarms**.
- 2 Select the alarm you want to customize.
- 3 Tap **On**, set the value, then click **Save**.
- 4 Select **Override Do Not Disturb** if you want an alarm to display even when your smartphone is muted or Do Not Disturb is enabled.

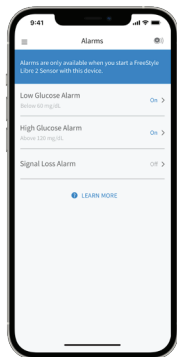

On the reader:

- 1 Click the gear to go to **Settings**.
- 2 Select **Alarms**.
- 3 Click **Change Alarm Settings** and select which alarm you'd like to set and turn on.



Detailed reports

You can find your reports on the FreeStyle LibreLink App

- On your smartphone, in the main menu,
- Or
- On your reader, from the home screen, go to the “view history” section

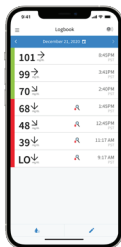

Logbook

View your glucose history and add notes to track food, insulin use, exercise & other events.



Time In Range¹⁰

Know exactly when your readings were above, below or within the target range.

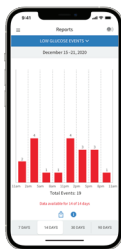

Low Glucose Events

Recorded when readings are lower than 70 mg/dL for more than 15 minutes

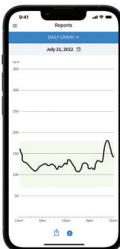

Daily Graph

Check the time you've spent in your target range each day as indicated by the green band on the graph.

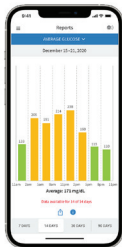

Average Glucose

Shows average glucose readings based on the time period you select.

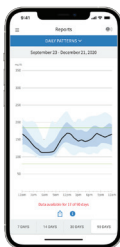

Daily Patterns

Shows the pattern and variability of your readings over a typical day.



Sensor Usage

Shows how much of your glucose data is captured by each sensor.



Estimated HbA1c

Get an estimate of your HbA1c based on your available glucose data from last 90 days.

Easily share real-time readings with your loved ones and doctor to keep them in the loop



Loved ones can access your glucose information in real time.



Your doctors can use this secure, cloud-based system to see your glucose data, making it easier to have discussions and make decisions together.



Sharing with your caregiver

- Send an invitation to download LibreLinkUp App[#] and share data
- You can connect with up to 20 people.
- Once they accept your invitation, you can set the last 12 hours of glucose readings in a simple, interactive graph.

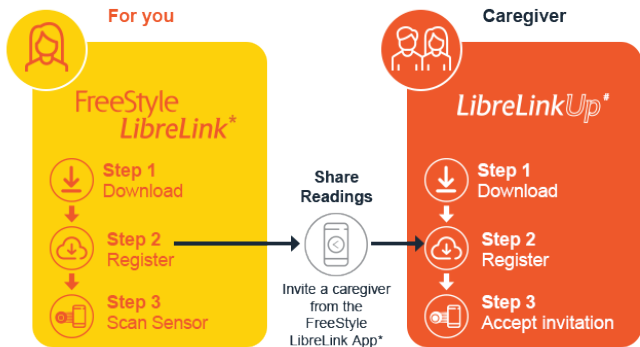



Sharing with your doctor

- Get easy-to-understand reports and optimize your treatment plans with your healthcare professional.
- Each time you scan your sensor with the FreeStyle LibreLink App*, your glucose data is automatically updated to LibreView^ - a secure, cloud-based platform.

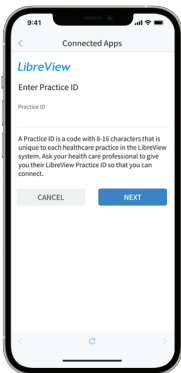

- 1 Ask your healthcare professional or office staff to provide their LibreView^ Practice ID, which is a code specific to your healthcare professional's practice
- 2 Then simply enter the ID in the FreeStyle LibreLink App*
- 3 GO TO: Menu > Connected Apps OR Share > LibreView^ > Connect to a Practice > Enter Practice ID

Living with FreeStyle Libre 2



Pat dry

After a shower or swim, take extra care when towelling off to avoid catching or pulling off your sensor.



Slow down

When dressing or undressing, take care to avoid catching your undergarments on the sensor.



Dress for success

Give your sensor room to breathe by wearing loose-fitting clothing.



Easy does it

Be careful to move slowly on a doorway, car door, seat belt or furniture edges.



Contact sports and heavy exercise

Select a site on the back of your upper arm that will minimise the risk of knock off.



Hands off

Try not to play with, pull, or touch the sensor while wearing it.

Travelling with FreeStyle Libre 2



Heading somewhere hot?

FreeStyle Libre 2 Plus sensors are water resistant for 30 minutes and up to depth of one metre.



Travelling by air?

Put your extra FreeStyle Libre 2 Plus sensors in your carry-on bag. Check your airline's policy on NFC and Bluetooth devices, and plan accordingly.



Visiting somewhere cold?

You can scan your FreeStyle Libre 2 Plus sensor through clothing with a thickness of 4cm.



Speeding through security?

You can go through airport metal detectors, but some full-body scanners may damage the sensor or cause inaccurate results. Consider requesting another type of screening



Going overseas?

Your FreeStyle Libre 2 reader or FreeStyle LibreLink App* may not be compatible with FreeStyle Libre 2 Plus sensors purchased in other countries, so make sure you pack enough sensors to last the duration of your trip.

Removing and Replacing the FreeStyle Libre 2 Plus sensor



- 1** Pull the adhesive edge that fixes the sensor to your skin. Slowly remove in a single movement



- 2** When applying a new sensor, select a different site

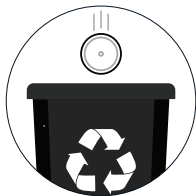

- 3** Follow your local regulations for electronic equipment, batteries, sharps, and materials that are exposed to bodily fluids to dispose of your sensor.



Checklist

Please ensure you have completed the steps below to stay connected



Near Field Communication (NFC)

Check the compatibility of your mobile phone.
Scan the QR code to view the compatibility guide.



Active E-mail address

Ensure you have a current and active e-mail address which will be used to create your FreeStyle LibreLink account.



Download the FreeStyle LibreLink App*

to get started Scan the QR code to download the App.



Get started

Scan the QR code to view sensor application video



Frequently Asked Questions

Scan the QR code to understand Frequently asked questions about FreeStyle Libre.



FreeStyle Libre 2 system

Q.1 What is FreeStyle Libre 2 system?

The FreeStyle Libre 2 system tracks your glucose levels real-time with your smartphone. FreeStyle Libre 2 Plus sensor is an easy to apply and comfortable to wear for 15 days⁷. The system has optional alarms¹ to alert you the minute your glucose is too high or too low. You can swim, shower and exercise¹⁶ while wearing it.

Q.2 Can the FreeStyle Libre 2 Plus be used by children?

The FreeStyle Libre 2 Plus Flash Glucose Monitoring System Sensor ('Sensor'), when used with a compatible device, is indicated for measuring interstitial fluid glucose levels in people (age 2 and older) with diabetes mellitus, including pregnant women. The Sensor and compatible device are designed to replace blood glucose testing in the self-management of diabetes, including dosing of insulin.

The indication for children (age 2 - 12) is limited to those who are supervised by a caregiver who is at least 18 years of age. The caregiver is responsible for managing or assisting the child to manage the reader and sensor and also for interpreting or assisting the child to interpret sensor glucose readings.

Q.3 How should the FreeStyle Libre 2 system be stored?

Both the reader and the sensor should be stored between 4°C and 25°C in a cool dry place away from direct sunlight.

Alarms

Q.4 How many alarms does the FreeStyle Libre 2 system have?

The FreeStyle Libre 2 system has three optional alarms:

 Low Glucose Alarm - an alarm will notify you when your glucose falls below a level you set

 High Glucose Alarm - an alarm will notify you when your glucose rises above a level you set

 Signal Loss Alarm - an alarm will notify you when the glucose alarms you set are not available because your Sensor has lost communication with the Reader or app for 20 minutes.

Q.5 Why are the alarms optional?

Not all patients need glucose alarms. The FreeStyle Libre 2 system offers alarms for those who need or desire them. However, all patients can simply choose to keep the alarms turned off.

Q.6 How do glucose alarms work on FreeStyle LibreLink App?

When glucose alarms¹ are enabled, the FreeStyle LibreLink App* notifies you the minute your glucose crosses the level that is set for that specific alarm.

Q.7 What if my phone is being too far away from me?

A Signal Loss alarm in FreeStyle LibreLink App* will notify you when the sensor has not communicated with the App for 20 minutes, typically when the sensor being too far away from your smartphone ie over 6 meters (20ft)

Additionally, the Signal Loss Alarm can occur if Bluetooth is turned off, or another issue such as an error or problem with your sensor.

FreeStyle LibreLink App*

Q.8 What is the FreeStyle LibreLink mobile app?

The FreeStyle LibreLink App* enables you to receive automatic glucose readings, every single minute³, straight to your smartphone, without the need to scan³.

WITH FREESTYLE LIBRELINK APP* YOU CAN:



- View your current glucose reading, a trend arrow, which indicates how your glucose is changing, and the last 8-hours of glucose history
- See glucose reports, including your Ambulatory Glucose Profile, which reveal trends and patterns
- Add notes to track your food, insulin use, exercise, and other events

- Connect to healthcare professionals and caregivers with LibreView[^] and LibreLinkUp[#]
- Set optional alarms to alert you to high or low-glucose events

Important: You must have a compatible iPhone or Android phone to install and use the app (See Compatibility Guide).

Q.9 Do I still scan my sensor with my smartphone?

With FreeStyle Libre 2 Plus sensor, you no longer need to scan³ your sensor to receive glucose readings. You need to scan³ to start a new sensor, enter a glucose reading into your logbook, or backfill up to 8 hours' worth of data if your sensor has been disconnected from your phone.

Q.10 Can I use my FreeStyle Libre 2 reader and FreeStyle LibreLink App* with the same sensor?

Yes, it is possible to use both your FreeStyle Libre 2 reader and the FreeStyle LibreLink app with your FreeStyle Libre 2 Plus sensor. If using both devices with the Sensor, the FreeStyle Libre 2 Plus sensor will not stream real-time glucose readings to the app. You will need to scan³ your sensor with the reader or FreeStyle LibreLink App* to receive a glucose reading.

Q.11 Can my healthcare professional access my reports remotely e.g. over the internet or cloud?

The FreeStyle LibreLink App* will automatically sync your glucose data to LibreView^, which is a secured cloud-based solution and your healthcare professional will be able to access from any compatible internet-connected device.

Q.12 Do I need to keep the App running in the background and if so, will that drain my phone battery?

Yes, it is required to keep the FreeStyle LibreLink App* running in the background.

It is required to keep the FreeStyle LibreLink App* running in the background when using the alarms functionality and to receive real-time glucose readings.

We have not seen a reduction in mobile phone battery life for users receiving real-time glucose readings.

Q.13 Do I need to keep my Bluetooth On?

Yes, you need to keep your bluetooth on, to receive the data automatically every minute³.

Q.14 What is the sensor transmission range to receive real-time glucose readings and/or glucose alarms?

You must be within 6 meters (20ft) unobstructed.

Q.15 What if I move out of the sensor transmission range of 6 meters (20ft)?

You can still scan the sensor with App to backfill the data. If a user discovers a gap in their glucose data on the graph, they can scan their FreeStyle Libre 2 Plus sensor with the FreeStyle LibreLink App* to recover and fill in data from the last 8 hours.

Q.16 Will the App alert users that they have a data gap on their graphs?

Yes, the App will prompt users once per sensor whenever a gap > 2 hours appears on the glucose graph.

Q.17 How many hours of data can a I backfill if their sensor and App disconnect?

You can scan anytime to recover data from the last 8 hours.

Q.18 Will my sensor still work if I update my OS to a version that meets the minimum operating system requirements listed in the Compatibility Guide mid wear?

Yes. Your sensor will continue to work for the remainder of its wear duration after you update your OS to a version that meets the minimum operating system requirements listed in the Compatibility Guide.

Q.19 What happens if I lose or change my phone?

If you lose your phone, download the app again on a compatible phone and sign in with your account information. If you have an active sensor and need to reinstall the app, when you sign into your existing account, you can continue using your active sensor until the end of its useful life. You will not be able to view historical data in the new installation of the app, but this data will be available in LibreView[^].

LibreView[^]

Q.20 What is LibreView[^] and how does it work with the FreeStyle LibreLink App*?

LibreView is a cloud-based diabetes management system provided by Abbott. LibreView provides a secure repository for data from your FreeStyle LibreLink App*, and allows you to easily share your glucose data with your healthcare professional or others, if you wish. Data is automatically uploaded to LibreView[^] when your phone is connected to the Internet.

Q.21 Is my data safe? What will Abbott do to protect patient data?

Abbott and its partners comply with all applicable data protection and privacy laws in users' jurisdictions. Please read

the Terms of Use and the Privacy Notice within the app or at FreeStyleLibre.com.in to ensure that you are comfortable with the data handling practices that govern the use of the app and LibreView[^].

LibreLinkUp[#]

Q.22 What is LibreLinkUp[#]?

LibreLinkUp[#] is a free-to-download mobile app that allows parents and other caregivers to receive glucose readings from you who uses the FreeStyle LibreLink App* to obtain glucose readings from their FreeStyle Libre 2 Plus sensor.

Q.23 How do I share my glucose data with caregiver?

Once the LibreLinkUp[#] App has been installed on your caregiver's phone and an invitation to connect has been sent to them from FreeStyle LibreLink App*, they can receive your glucose information on their smartphone every single minute³ from your FreeStyle Libre 2 Plus sensor.

As long as you have opened and signed in to the LibreLinkUp[#] app at least once, you will receive notifications even if you have closed out of the app. The LibreLinkUp[#] app does not need to be open or running for you to receive notifications; the notifications can be sent to your phone's lock screen.

Q.24 With how many caregivers, do I share my data?

The LibreLinkUp[#] app allows caregivers to make connections with up to twenty (20) FreeStyle LibreLink users. Likewise, FreeStyle LibreLink users can share glucose information with up to twenty (20) LibreLinkUp connections.

Q.25 What information is visible on LibreLinkUp[#]?

LibreLinkUp[#] users can view glucose readings and the trend arrows which show the direction the glucose is heading. you can also share it with your healthcare professional

*The FreeStyle LibreLink app is only compatible with certain mobile devices and operating systems. Please check the website for more information about device compatibility before using the app. Use of FreeStyle LibreLink requires registration with LibreView.

#The LibreLinkUp app is only compatible with certain mobile devices and operating systems. Please check www.librelinkup.com for more information about device compatibility before using the app. Use of the LibreLinkUp app requires registration with LibreView. Dosing decisions should not be made based on this device. The user should follow instructions on the continuous glucose monitoring system. This device is not intended to replace self-monitoring practices as advised by a physician.

^The LibreView data management software is intended for use by both patients and healthcare professionals to assist people with diabetes and their healthcare professionals in the review, analysis, and evaluation of historical glucose meter data to support effective diabetes management. The LibreView software is not intended to provide treatment decisions or to be used as a substitute for professional healthcare advice.

\$Use the FreeStyle LibreLink app to automatically sync your glucose data to LibreView or upload from a FreeStyle Libre reader manually to your computer with a compatible data cable.

References

1. Notifications will only be received when alarms are turned on and the sensor is within 6 meters unobstructed of the reading device.
2. Finger pricks are required when readings and alarms do not match symptoms or expectations
3. When used with FreeStyle LibreLink App
4. Haak, T. Diabetes Therapy (2017): <https://doi.org/10.1007/s13300-016-0223-6>.
5. Unger, J. Postgraduate Medicine (2020): <https://doi.org/10.1080/00325481.2020.1744393>.
6. Data on File, Abbott Diabetes Care, Inc.
7. Alva, S. J Diabetes Sci Technol (2020): <https://doi.org/10.1177/1932296820958754>.
8. Hilliard, M., et al. Diabetes Technology & Therapeutics. (2019): <https://doi.org/10.1089/dia.2019.0142>
9. Leelarathna, L. N Engl J Med. (2022): DOI: 10.1056/NEJ-Moa2205650
10. Yaron, M. Diabetes Care (2019): <https://doi.org/10.2337/dc18-0166>.
11. Bolinder, J. Lancet (2016): [https://doi.org/10.1016/S0140-6736\(16\)31535-5](https://doi.org/10.1016/S0140-6736(16)31535-5).

12. 60-minute warm-up required when applying the sensor.
13. Sensor is water resistant in up to 1 meter (3 feet) of water. Do not immerse longer than 30 minutes.



In case of any query, please get in touch with our FreeStyle Customer Service Team at:

 1800 2100 998

 adc-cs.in@abbott.com

FreeStyle Customer Care Hours: 8:30am – 5:30pm,
Monday to Friday Excluding Saturday, Sunday and national public holidays.



Scan to visit our website
www.FreeStyleLibre.co.in



Disclaimer: Images and readings are for illustration purposes only. No actual patient data. Any person depicted in the photos is a model. The information mentioned in this document is only suggestive/for patient education and shall not be considered as a substitute for doctor's advice or recommendation from Abbott. Please consult your doctor for more information.

Corporate Address: Abbott Healthcare Pvt. Ltd., Floor 16, Godrej BKC, Plot No. C- 68, BKC, Near MCA Club, Bandra (E), Mumbai - 400 051.

Registered Address: Abbott Healthcare Pvt. Ltd., 3, Corporate Park, Sion-Trombay Road, Chembur, Mumbai – 400071.

Information contained herein is for distribution outside of the USA only.

© 2025 Abbott. All rights reserved. The sensor housing, FreeStyle, Libre, and related brand marks are marks of Abbott. ADC-114941 v1.0